



INSTRUCTION MANUAL

#92200 OTR O-RING INSTALLER TOOL UP TO 30" RIMS



WARNING!

To avoid serious personal injury, always wear proper protective gear, such as hard hats, safety glasses, gloves, and steel toe shoes when using hydraulic equipment. Failure to chock the wheels and crib the vehicle can result in serious injury or death. Always deflate tires before removing a wheel, a rim, or part of a rim clamp or nut. If you do not deflate the tire, the tire could explode, causing serious injury or death.

Always stand to one side of the rim when using the bead breaker. Standing to one side of the bead breaker allows you to maintain control of the bead breaker. If it is not seated properly and flies off the rim, the bead breaker could cause serious injury or death.

Operating Instructions

CAUTION!

BEFORE USING THIS TOOL, READ INSTRUCTIONS THOROUGHLY. THE USE OF THIS TOOL IN ANY OTHER APPLICATION IS BOTH A VOID OF WARRANTY AND CAN LEAD TO INJURY OR EVEN DEATH.

After placing a bead flange as far inside the bead of the tire as possible, do as follows to accomplish full installation of the tire onto wheel assembly

1. Place bottom cross bar, the bar with the two black ends inside of the wheel at twelve and six o'clock position. Make sure the gripping plates are tight against the inner bevel of the wheel, adjust by loosening set bolts and sliding out until the tighten set bolts, adjust bottom gripping plate and then top, making sure it is as centered as possible.
2. Hang the "O" Ring on the top set bolt of the bottom cross bar so as out of the way until installation of "O" Ring.
3. Slide top cross bar assembly over the threaded center rod at the nine and three o'clock positions, so that the push bar lines up against the rim flange. Adjust for the tire diameter of the wheel by loosening and tightening set bolts as needed.

4. Depending on amount of travel left on the threaded center rod choose a round spacer or spacers and slide onto the threaded center rod.
5. Turn the handle clockwise onto the threaded enter rod, simply turn while standing to one side until the push feet press against the rim flange, pushing the rim flange and bead of tire pass the "O" Ring groove easy installation of the "O" Ring.

NOTE: If the hand crank becomes hard to turn this usually means that the bead flange is slightly uneven with the wheel, simply tap the bead flange with a hammer and continue turning the hand crank.

6. After you have installed the "O" Ring you can also install the locking-ring.
7. After the locking-ring is locked into place turn the hand crank counter clockwise until off of the threaded center rod.

NOTE: Hold pressure onto the top cross bar until with one hand at the beginning until you have the hand crank threaded against spacer or spacers, and at the end while removing hand crank from the threaded center rod. Simply remove device from wheel and inflate the tire.

WARNING!

This product as well as all tire tools should never be used by persons unless they have been properly trained according to O.S.H.A. Regulation #29CFR1910.177 entitled "Servicing Single-Piece and Multi-Piece Rim Wheels."

AME INTERNATIONAL

2347 Circuit Way, Brooksville, Florida USA 34604

Phone: (+1) 352.799.1111 • Toll Free (+1) 877.755.4AME (4263)

Fax: (+1) 352.799.1111 • E-mail: sales@ameintl.net

Parts Breakdown

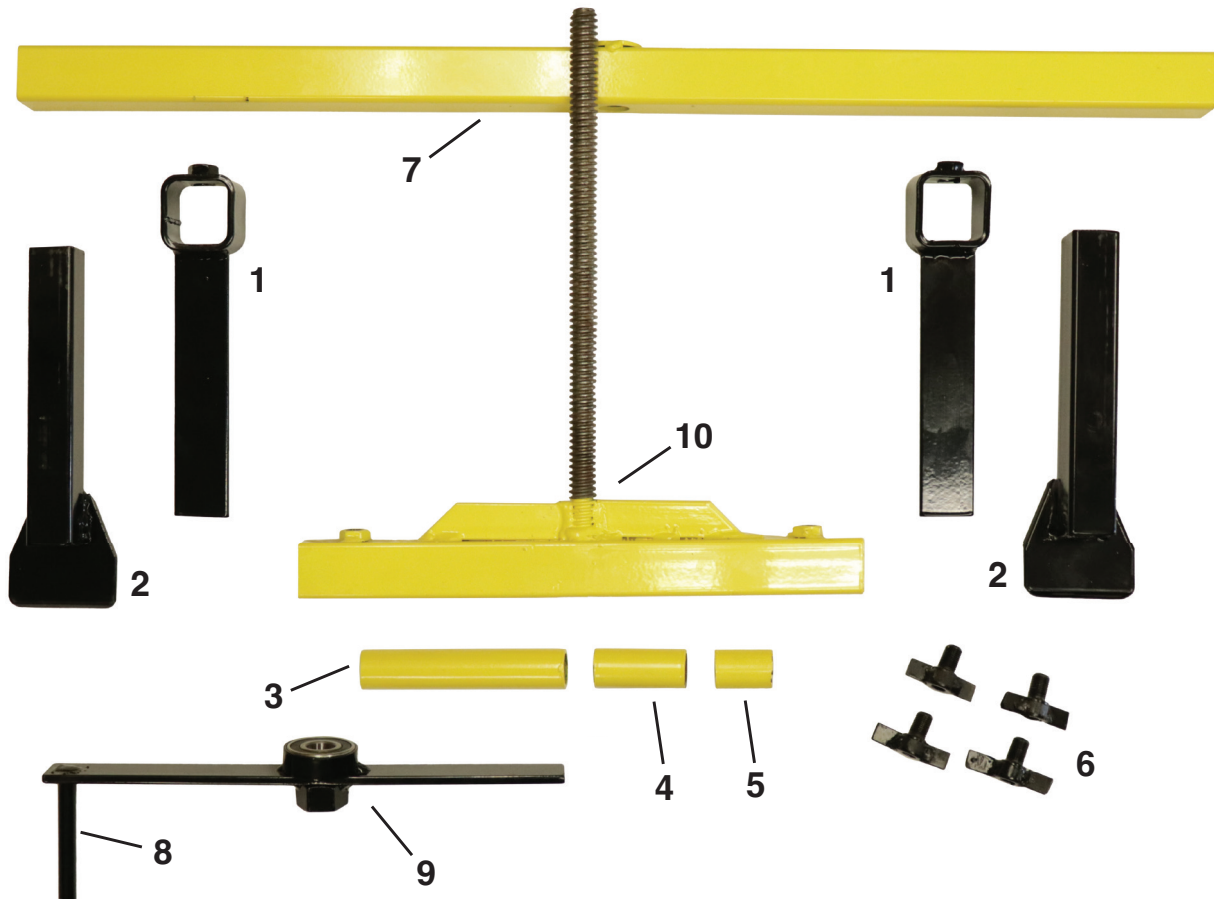

ITEM NO.	PRODUCT NO.	DESCRIPTION	QTY.
1	92200-001	Arm	2
2	92200-002	Foot	2
3	92200-SPK	5 9/16" Spacer	1
4	92200-SPK	3 1/8" Spacer	1
5	92200-SPK	1 9/16" Spacer	1
6	92200-007	Black Wing Nuts	4
7	92200-008	Frame	1
8	92200-009*	Handle	1
9	92200-010*	Crank	1
10	92200-011	Pull Bar with Threaded Rod	1

* 92200-009 & 92200-010 must be purchased together.